



## Vacuum Packers Vacuum packer 60m<sup>3</sup>/h on wheels

ITEM # \_\_\_\_\_

MODEL # \_\_\_\_\_

NAME # \_\_\_\_\_

SIS # \_\_\_\_\_

AIA # \_\_\_\_\_



**602337 (DVP60D)**

Vacuum Packer, 60 m<sup>3</sup>/h,  
sealing bar front/rear  
2x620mm, on wheels

### Short Form Specification

Item No. \_\_\_\_\_

Vacuum packer on wheels, made in 304 AISI stainless steel with domed transparent PMMA Plexiglas lid. Vacuum level control through high-precision sensor. Pressure chamber with rounded corners for easy cleaning. Digital control panel with 10 editable user programs (vacuum, extra vacuum, sealing time, gas percentage). External vacuum in bags or containers possible. Display shows alarm messages if malfunctions are detected (e.g. oil cleaning cycle needed). 3 PE filling plates included. Equipped with two sealing bars 620 mm each, on front/rear. Optional Bluetooth label printer available, for HACCP compliance.

### Main Features

- Vacuum packer on wheels with oil lubricated vacuum pump.
- Vacuum level control through high-precision sensor.
- Pressure chamber made of constant thickness, hydroformed, stainless steel with rounded corners for easy cleaning.
- Sturdy, transparent PMMA (plexiglass) lid with rounded edges; opens automatically at the end of the cycle.
- Control panel, resistant to liquids, humidity, dirt and dust.
- 10 editable user programs (vacuum, extra vacuum, sealing time, gas percentage).
- Adjustable sealing time 0.1 to 6 seconds.
- Specific pump oil cleaning cycle (H2Oout).
- Automatic warnings if food needs cooling down (hot), failure in the packing process, gas missing, oil change.
- 3 PE filling plates included.
- Equipped with two sealing bars 620 mm each, on front/rear, easily removable for cleaning.
- With device to lift the removable sealing bar.
- Unit pre-arranged to be connected to an inert gas system.

### Construction

- Entirely constructed in 304 AISI stainless steel.
- Free-standing appliance mounted on 4 castors, 2 with brakes.
- Easily accessible oil drain.
- Chromed aluminium die-cast hinges.

### Optional Accessories

- Inclined shelf to vacuum liquids, 300mm (for models with 310mm sealing bar or multiples) PNC 650240 ☐

APPROVAL: \_\_\_\_\_



## Vacuum Packers Vacuum packer 60m<sup>3</sup>/h on wheels

Front

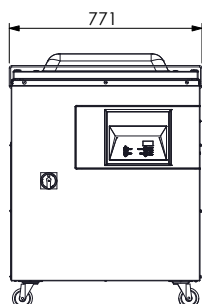

Side

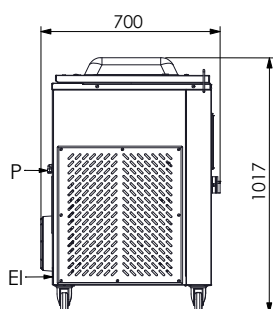

**EI** = Electrical inlet  
(power)

Perspective

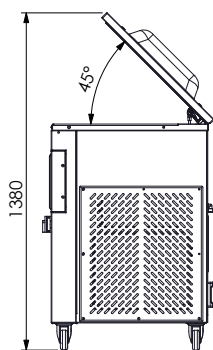

Top

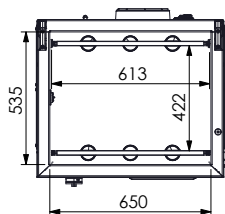

Other

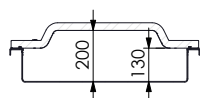

### Electric

<b>Supply voltage:</b>	400 V/1N ph/50-60 Hz
<b>Total Watts:</b>	1.5 kW

### Key Information:

<b>Filling board nr:</b>	3
<b>Gas nozzles:</b>	4+4
<b>External dimensions, Width:</b>	697 mm
<b>External dimensions, Depth:</b>	772 mm
<b>External dimensions, Height:</b>	1034 mm
<b>Net weight (kg):</b>	168.5
<b>Well Capacity:</b>	61 lt
<b>Pump:</b>	60 m <sup>3</sup> /h
<b>Sealing bar position:</b>	Front+Rear
<b>Sealing bar length:</b>	620 mm
<b>Max chamber (chamber + cover) dimensions:</b>	536 x 650 x 200 mm
<b>Chamber working dimensions:</b>	430 x 545 x 130 mm

Vacuum Packers  
Vacuum packer 60m<sup>3</sup>/h on wheels

The company reserves the right to make modifications to the products without prior notice. All information correct at time of printing.

2025.06.12

